

neo Advance® | Flat Fixed- Components (supplied)

- A. IGU glazing
- B. Thermoliner
- C. Rooflight frame
- D. Fixing screw
- E. Cover trim
- F. Packer

Contractor components (not supplied)

- 1. Continuous silicone seal to top
- 2. Structural kerb
- 3. Insulation
- 4. Structural ply
- 5. Plaster board
- 6. Plaster skim
- 7. Vapour barrier
- 8. Fillet
- 9. Roofing membrane
- 10. Roof deck
- 11. Furring
- 12. Structural member

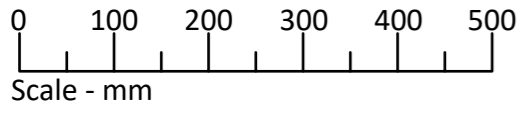
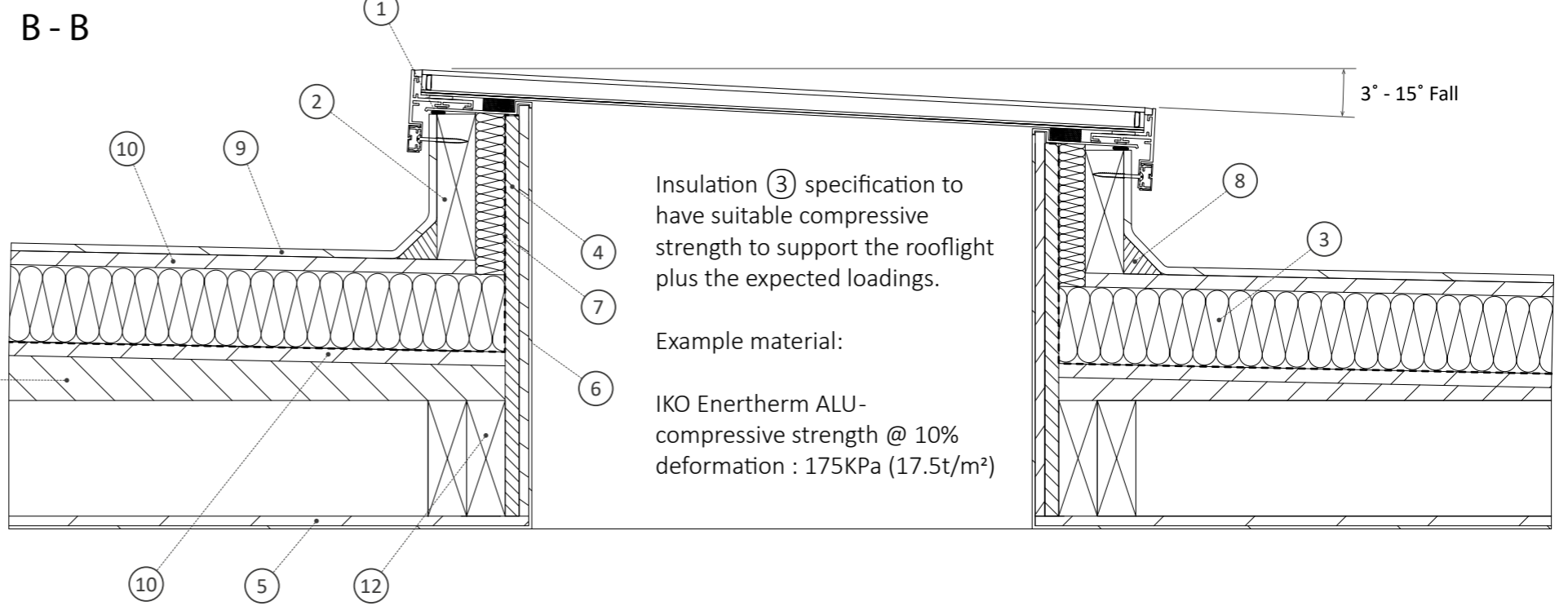

*Dependant on glass specification / thickness

This is a suggested installation detail which may not be exactly applicable to all situations and constructions. It is not a detailed or constructional proposal. Installers and designers are advised to check their own details for compliance with all currently applicable Local Authority by-laws, Acts of Parliament and British / ISO standards. This detail does not specify a kerb height. We recommend that installers follow the guidance outlined in BS6229:2003 - Flat roofs with continually supported coverings - code of practice.

1 2 3 4 5 6

<p>TITLE :</p> <h1 style="margin: 0;">Neo Advance® Flat Fixed Rooflight</h1> <p style="font-size: small; margin: 0;">> A rooflight range suitable for flat roofs between 3° and 15°</p> <p style="margin: 0;">Warm Roof Kerb installation detail</p>	<p>DWG NO. : NFF-001INST_B</p> <p>SCALE : 1:8 @ A3</p> <p style="font-size: x-small;">This is a suggested installation detail which may not be exactly applicable to all situations and constructions. It is not a detailed or constructional proposal. Installers and designers are advised to check their own details for compliance with all currently applicable Local Authority by-laws, Acts of Parliament and British / ISO standards.</p>	<p>SHEET NO. : 1 OF 1</p> <p>DATE : 19/07/2023</p> <p style="font-size: x-small;">This is a suggested installation detail which may not be exactly applicable to all situations and constructions. It is not a detailed or constructional proposal. Installers and designers are advised to check their own details for compliance with all currently applicable Local Authority by-laws, Acts of Parliament and British / ISO standards.</p>	<p>REVISION:</p> <div style="font-size: 2em; font-weight: bold; margin: 10px 0;">B</div> <p style="font-size: x-small; margin: 0;">Updates to formatting.</p> <p style="font-size: x-small; margin: 0;">DB: NTCB: PD</p>	<p style="margin: 0;">THE</p> <h2 style="margin: 0;">ROOFLIGHT CO.</h2> <p style="margin: 0;">COTSWOLDS</p> <p style="font-size: x-small; margin: 0;">w: www.therooflightco.com t: 01993 833 108 e: hello@therooflightco.com</p>	<p>The Rooflight Co is a trading name of The Metal Window Company Limited - Company No. 2881879. All information contained within this drawing is copyright © and design right of The Metal Window Company Limited. The intellectual property rights of the products detailed within this drawing and embedded 3D models are owned by The Metal Window Company Limited.</p>
--	---	---	---	--	---