

Critical: Clear structural opening sizes

Please note - Bearer opening sizes shown in this 'Between the rafter' detail are equal to structural sizes for 'On the rafter' installations.

Before creating the clear structural opening size, please verify that part 8b will provide the minimum 5 degree fall for shedding rain water at the cill.

This will be based on the size of the cill bearers (Value Y) which will vary according to changes in the roof pitch (Value Z) and height of roof build up above the rafters (Value X).

In this example; Value Y is 150mm, based on a Value X being 60 and Value Z being 30 degrees.

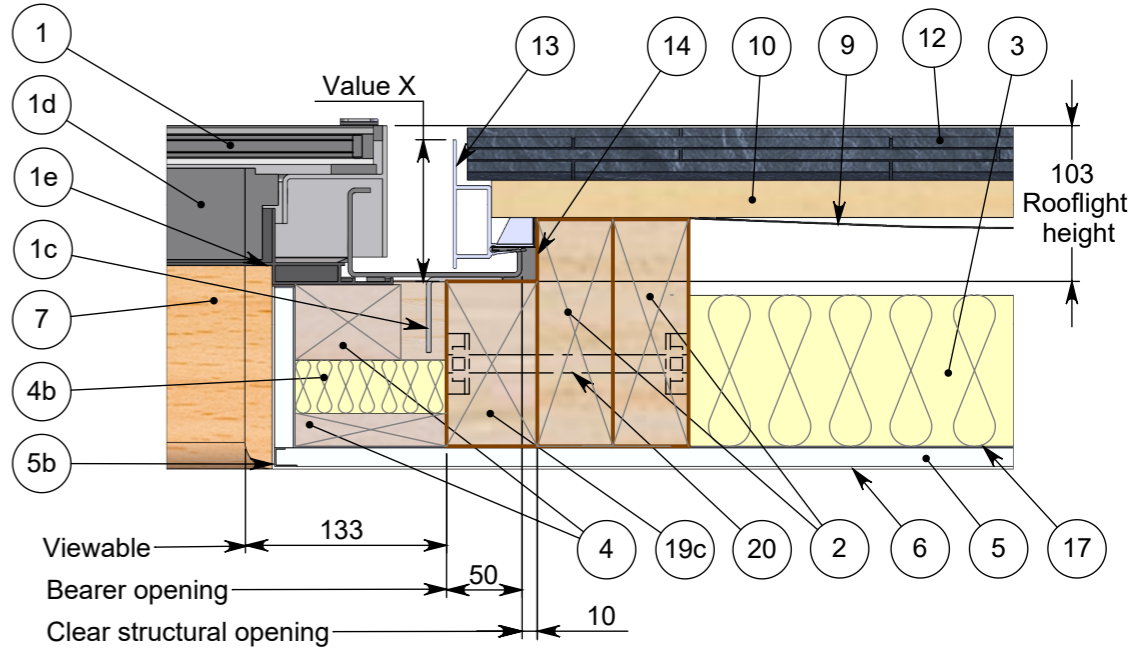

Key:

1. The neo-steel Rooflight, with Manual opening option 1b fixed to bearers 19c at jamb using coach bolts fitted through fixing rail 1c.
2. Structural rafter support at jamb and structural trimmer support at head and cill 2b.
3. Insulation fitted between structural supports.
4. Fix timber packers to bearers 19, 19b and 19c to which plasterboard / timber lining is fixed. Fit insulation between the timber packers 4b.
5. Plasterboard lining with plasterboard stop to protect the corner. Plasterboard fitted behind the thermoliner of the roof window 1e.
6. Plaster skim.
7. Timber reveal to align with rooflight linings 1d to provide 'frameless' internal appearance. Rooflight linings 1d MUST BE PAINTED with a timber finishing paint once the rooflight is installed to ensure longevity of this component. If the linings have been factory painted, they do not require an additional paint finish.
8. Head hardwood tilting fillet.
- 8b. Cill hardwood tilting fillets - to provide minimum 5 degree fall for shedding rain water.
- 9 & 16. Line of general roofing membrane.
10. Softwood battens.
11. Code 3 (consider using code 4 and clipping down roof tiles in severer exposures) lead flashing at head. Carry flashing up the roof and lap UNDER general roofing membrane 9, 16 and UNDER head membrane 15.
- 11b. Code 4 (consider clipping flashing and roof tiles down in severer exposures) lead flashing at cill over tilting fillet 8b. Make the flashing long enough to give triple lap to the tiles below.
12. Roofing tiles.
13. Jamb flashing assembly - uPVC soaker upstand. Maximum installed height from top of soaker to top of structural support is 124mm. Trim soaker to accommodate differing tile types. Refer to the Flashing Kit installation guide for more information.
14. Perimeter silicone seal. Seal perimeter of rooflight 1 JUST PRIOR TO installation of the rooflight using a thick continuous bead of low modulus neutral cure silicone sealant. Ensure sealant to cill 14b is located in a position where it will be covered by the cill flange of the rooflight.
15. Roofing membrane to rooflight head. Dress UNDER general roofing membrane 16, UNDER lead flashing 11 and OVER general roofing membrane 9 to ensure suitable lap.
17. Vapour barrier.
18. Softwood batten to be fitted under head tilting fillet.
19. Bearers support the rooflight and transfer the load to the rafter 2 and trimmer 2b structural support members. The size of cill bearers (Value Y) 19b is determined from the roof pitch (Value Z), depth of the roof build up (Value X) and ensuring that the tilting fillets 8b provide the minimum 5 degree fall.
20. Suggested fixings; Threaded rods to secure the bearers 19, 19b and 19c to the structural support members 2, 2b.

Please Note:
 These sectional details are provided as an installation suggestion. Due to the differing nature of installations we strongly advise you to consult your rooflight installer to verify fitness for purpose. This drawing does not constitute a structural proposal. Sufficiency of structural supports to be checked by rooflight purchaser's structural consultant.

TITLE : Neo Rooflight ® > A roof window range suitable for pitched roofs between 20° and 60° Cold Roof Slate Flashing Kit 'Flush slate' installation detail	DWG NO. : SN_CRSF_FK_B	SHEET NO. : 1 OF 1	REVISION:
	SCALE : 1:5 @ A3	DATE : 19/07/2023	B Updates to formatting. DB: EH CB: PD
This is a suggested installation detail which may not be exactly applicable to all situations and constructions. It is not a detailed or constructional proposal. Installers and designers are advised to check their own details for compliance with all currently applicable Local Authority by-laws, Acts of Parliament and British / ISO standards.			
THE ROOFLIGHT CO. COTSWOLDS		The Rooflight Co is a trading name of The Metal Window Company Limited - Company No. 2881879. All information contained within this drawing is copyright © and design right of The Metal Window Company Limited. The intellectual property rights of the products detailed within this drawing and embedded 3D models are owned by The Metal Window Company Limited.	
w: www.therooflightco.com		t: 01993 833 108 e: hello@therooflightco.com	